



Intelligent Automation

TUVQIPÁ ÁŮŸ^ { ææææ äÄŮ^&dæÄŮiæ^ÁŮ•cŸ •

simply the first



Rodless Cylinders
@bYUf; i JXys
9YWFJW5VH Uhcfs
A chcfğžGearheads
Air Cylinders
DbYi a UhjWJ Uj Yg
: F@žFittingsžHi VY
Vacuum Equipment



The complete world of modern compressed air management

Modern automation technology would not be possible without efficient compressed air treatment. With the comprehensive **airfit** series HOERBIGER-ORIGA is an established leader for compressed air management systems.



airfit covers all requirements between G1/8 and G2. All market requirements are available including standard components, special solutions and fully integrated compressed air management systems.

airfit components are completely modular, enabling highly specialised system solutions for specific applications to be produced, even in the smallest of quantities.

- Stop valves
- Pressure control valves
- Filter water separators
- Oil mist lubricators
- Start/stop valves
- Microfilters
- Activated carbon filters
- Central lubricators
- Injection lubricators
- Prop. pressure regulators
- Comprehensive accessories ... in all connection sizes and with many options



airfit control electric regulators



airfit also available as ATEX version

- with special functions
- with special pressure ranges (up to 45 bar and more)
- with special temperature ranges (-40 to +120° C)
- for special media e.g. oxygen, nitrogen, etc.



Membrane dryer
airfit dry

The innovative membrane technology and especially the patented purge air control makes the membrane dryer **airfit dry**, one of the leading devices of its kind. As an ideal end-of-line solution, it is particularly suited for highly sensitive areas like medical technology, electronics, as well as

mobile pneumatic applications and industrial automation. Exceptional performance is guaranteed, even in the most arduous environmental conditions

- No electrical connection
- No additional sensors or control elements
- No wear and tear due to the absence of mechanically moving parts
- Practically silent
- No alteration of the air composition
- Flexible depending on drying purpose
- Fast response
- Up to 16 bar



Microfilter MF - filtration efficiency 99.999%. Active carbon filter MC - residual oil content 0.003 ppm



Special devices upon customer request: valve maintenance combination unit

airfit light G1/8, G1/4
small, lightweight,
with an intelligent interior



airfit swing G1/8, G1/4, G3/8
the technically and economically
convincing solution



airfit A15 G1/2, G3/4
- for highest operating comfort
- with many individual components



airfit A25 G1 (G3/4)
a full one inch unit for the
harshest environments



airfit airfit A50 G2 (G11/2)
Main line devices for pressurised
lifting gear in the offshore region,
blow moulding machines, etc.



Characteristics Common to All airfit swing Units

Port sizes		G1/8, 1/4, 3/8 and NPTF
Operating pressure	$p_{1\min}$ bar	0
range, inlet	$p_{1\max}$ bar	16
Medium and ambient	T_{\min} °C	0
temperature range	T_{\max} °C	+ 50 at 10 bar (other temperatures on request)

Air Preparation Unit SFRL

comprising filter-water-separator, diaphragm pressure regulator and oil mist lubricator

Type		SFRL-1/8	SFRL-1/4	SFRL-3/8
Port size		G1/8	G1/4	G3/8
Weight (mass)	kg	0.95	0.95	0.95
Maximum	Q_{\max} l/min	610	825	790
flow rate	m^3/h	37	50	47

Air Preparation Unit SKL

comprising filter-regulator and oil mist lubricator

Type		SKL-1/8	SKL-1/4	SKL-3/8
Port size		G1/8	G1/4	G3/8
Weight (mass)	kg	0.75	0.75	0.75
Maximum	Q_{\max} l/min	560	890	790
flow rate	m^3/h	34	53	47

Filter-Regulator

Pressure regulator with filter-water-separator

Type		SK-1/8	SK-1/4	SK-3/8
Port size		G1/8	G1/4	G3/8
Pore size of				
filter element	μm	30 or 5 (marking)		
Condensate drainage		Manual, semiautomatic (with pressure relief) or fully automatic		
Weight (mass)	kg	0.35	0.35	0.35
Operating pressure	$p_{2\min}$ bar	0.5	0.5	0.5
range, outlet	$p_{2\max}$ bar	8 (4 or 15)	8 (4 or 15)	8 (4 or 15)
Maximum	Q_{\max} l/min	790	2280	3200
flow rate	m^3/h	47	137	192

Filter-Water-Separator, Dust Filter

Type SF	Filter-water-separator with centrifugal system and filter element
Type SFD	Dust filter with larger filter surface area for long service intervals, specially designed for use with dryers

Type		SF-1/8	SF-1/4	SF-3/8	SFD-1/8	SFD-1/4	SFD-3/8
Port size		G1/8	G1/4	G3/8	G1/8	G1/4	G3/8
Pore size of							
filter element	μm	30 or 5 (marking)			1	1	1
Condensate drainage		Manual, semiautomatic (with pressure relief) or fully automatic					
Weight (mass)	kg	0.25	0.25	0.25	0.25	0.25	0.25
Maximum	Q_{\max} l/min	990	1440	1520	1030	1340	1620
flow rate	m^3/h	59	86	91	62	80	97

Pressure Regulator

Spring-loaded, fully compensated diaphragm pressure regulator with secondary venting.

Option: through- p_1

Type		SR-1/8	SR-1/4	SR-3/8
Port size		G1/8	G1/4	G3/8
Weight (mass)	kg	0.3	0.3	0.3
Operating pressure	$p_{2\min}$ bar	0.5	0.5	0.5
range, outlet	$p_{2\max}$ bar	8 (4 or 15)	8 (4 or 15)	8 (4 or 15)
Maximum	Q_{\max} l/min	790	2850	3300
flow rate	m^3/h	47	171	198

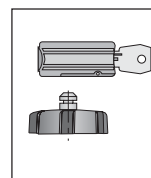

Oil Mist Lubricator

Oil mist lubricator with flow rate compensation

Type		SL-1/8	SL-1/4	SL-3/8
Port size		G1/8	G1/4	G3/8
Weight (mass)	kg	0.25	0.25	0.25
Maximum oil capacity	cm^3	45	45	45
Maximum	Q_{\max} l/min	1260	1830	1880
flow rate	m^3/h	76	110	113



Economy Lubricator

Micromist lubricator with wick principle

Type		SEL-1/4-3	SEL-1/4-4	SEL-1/4-5
Port size		G1/4	G1/4	G1/4
Maximum oil capacity	cm^3	45	45	45
Weight (mass)	kg	0.25	0.25	0.25
Minimum	Q_{\min} l/min	100	200	300
flow rate	m^3/h	6	12	18
Maximum	Q_{\max} l/min	500	800	1000
flow rate	m^3/h	30	48	60
Oil addition rate	mg/m^3	5-30 depending on application		

Soft Start Valve

Poppet valve with adjustable throttle for slow pressure build-up

Type		SDA-1/4	SDA-3/8
Port size		G1/4	G3/8
Weight (mass)	kg	0.35	0.35
Operating pressure	$p_{2\min}$ bar	2	2
range, outlet	$p_{2\max}$ bar	16	16
Maximum	Q_{\max} l/min	1500	1600
flow rate	m^3/h	90	96

Stop Valve

3/2 way poppet valve with pneumatic or electrical actuation and exhaust silencer

Type		SDR-1/4 P (E)	SDR-3/8 P (E)
Port size		G1/4	G3/8
Weight (mass)	kg	0.5 (0.8)	0.5 (0.8)
Operating pressure	$p_{2\min}$ bar	2	2
range, outlet	$p_{2\max}$ bar	16 (10)	16 (10)
Maximum	Q_{\max} l/min	1500	1600
flow rate	m^3/h	90	96

3/2 Way Shut-Off Valve

3/2 way shut-off valve, slide design

Type		SDV-1/4 XS	SDV-3/8 XS
Port size		G1/4	G3/8
Weight (mass)	kg	0.25	0.25
Maximum	Q_{\max} l/min	4100	5300
flow rate	m^3/h	246	318

airfit Swing

G1/8, G1/4, G3/8

Type: SFRL-1/8, 1/4, 3/8

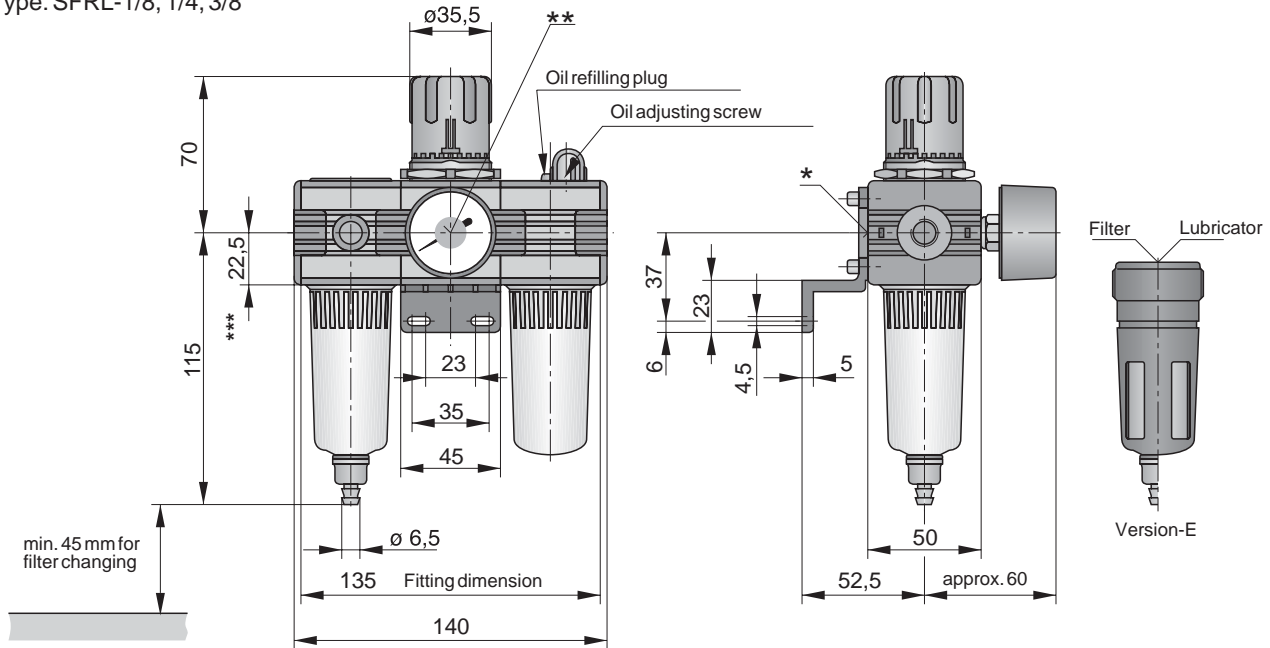

3/2 Way shut-off valve
Type: SDV-1/4X

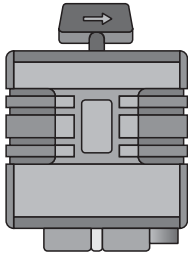

Order No.: PB 46749-001

Coupling kit

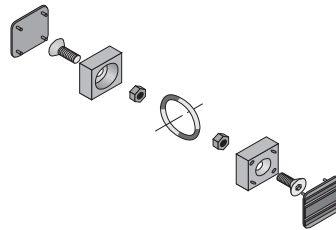

Order No.: PL 16959

Porting block kit, Type: SX
to provide unlubricated air.
For further details see 5.21.010E

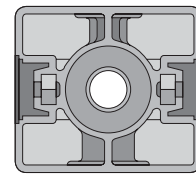

Order No.: PL 16969

Type: SFRL-1/4

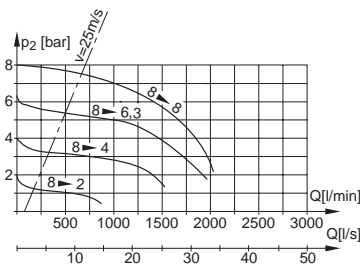

Type: SK-1/4

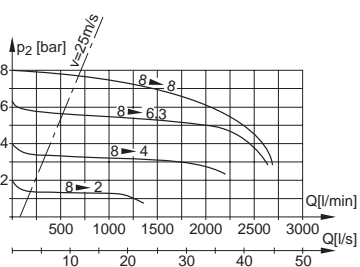

Type: SRE-1/4

Electronic Pressure Regulator

